

Panasonic

Before connecting, operating or adjusting this product, please read these instructions completely. Please save this manual.

Stereo Radio Cassette Player RQ-SW45V RQ-SW35V

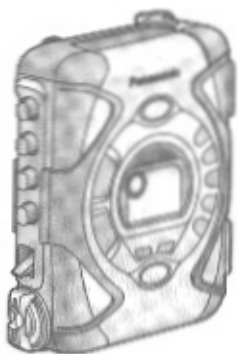

The serial number of this product can be found on the label affixed to the back of the cassette compartment cover.

Please note them in the space provided below and keep as a permanent record of your purchase to aid identification in the event of theft.

MODEL NUMBER _____

SERIAL NUMBER _____

Panasonic Consumer Electronics Company,
Division of Matsushita Electric Corporation of America

One Panasonic Way Secaucus, New Jersey 07094

Panasonic Sales Company, Division of
Matsushita Electric of Puerto Rico, Inc. ("PSC")
Ave. 65 de Infantería, Km. 9.5 San Gabriel Industrial
Park, Carolina, Puerto Rico 00985

Operating Instructions

P

RQTT0255-P
F1297E0 (D)

Supplied Accessories

- ① Stereo headphones
(RQ-SW45V) RFEV707P
(RQ-SW35V) RFEV708P
- ② Belt clip RGQT0023-K
- ③ Shockwave grip RGQT0018-K
- ④ Battery LR6PA/B

•To order accessories contact 1-800-211-7262 or web site (<http://www.panasonic.com>)

•Use numbers indicated when asking for replacement parts.

Be sure to give the model number and color of the unit when purchasing replacement headphones.

Attaching the belt clip and easy grip handle

■ Belt clip

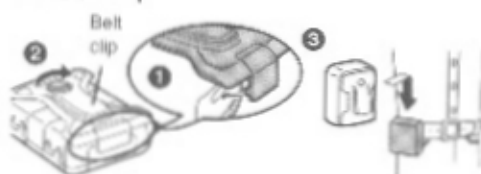

■ Grip handle

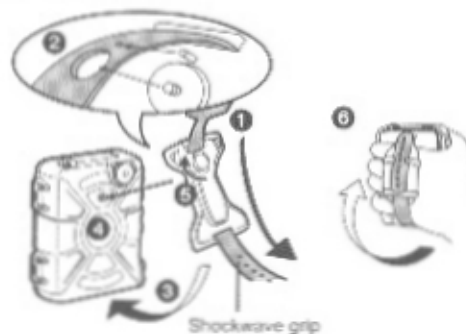

1

INSTALL A BATTERY.

One R6/LR6, AA, UM-3 (included) battery

2

CONNECT THE HEADPHONES.

Plug in firmly.

Plug type: 3.5 mm stereo

3

BATTERY CONDITION

Full Empty

CHANGING THE BASS

" " ↔ "VMSS" " " " ↔ "XBS" "

<RQ-SW45V> <RQ-SW35V>

TAPE

① INSERT A CASSETTE.

Forward side

When removing

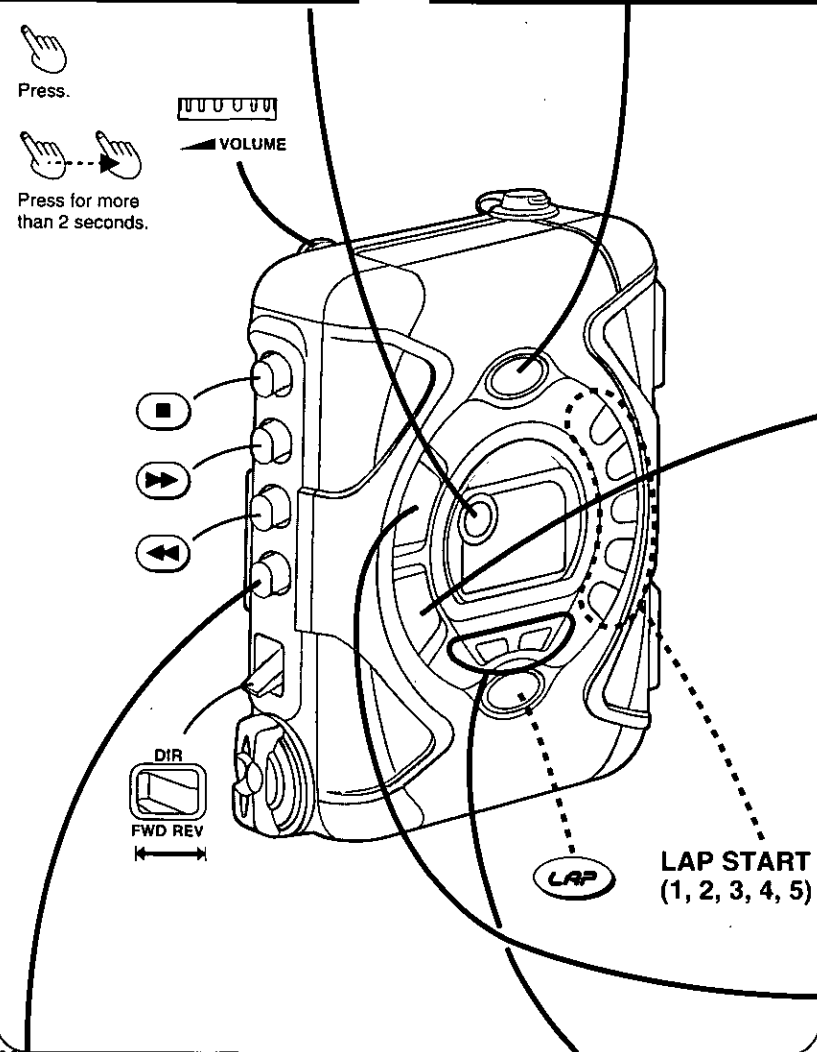

RADIO

① RELEASE HOLD.

"HOLD" ↔ RELEASE

② SELECT THE BAND.

→ "AM" → "FM" ←
"OFF" ←

② PRESS ◀ ▶.

TAPE

ADJUST THE VOLUME.

VOLUME

③ SELECT THE STATION.

TUNING

CAUTION:

This equipment has been tested and found to comply with the limits for a Class B digital device, pursuant to Part 15 of the FCC Rules. These limits are designed to provide reasonable protection against harmful interference in a residential installation. This equipment generates, uses and can radiate radio frequency energy and, if not installed and used in accordance with the instructions, may cause harmful interference to radio communications. However, there is no guarantee that interference will not occur in a particular installation. If this equipment does cause harmful interference to radio or television reception, which can be determined by turning the equipment off and on, the user is encouraged to try to correct the interference by one of the following measures:

- Reorient or relocate the receiving antenna.
- Increase the separation between the equipment and receiver.

- Connect the equipment into an outlet on a circuit different from that to which the receiver is connected.
- Consult the dealer or an experienced radio/TV technician for help.

FCC Notice: This system complies with new Part 15, except for the radio receiver, which complies with old Part 15, Subpart C of the FCC Rules. Operation is subject to the following two conditions: (1) This device may not cause harmful interference, and (2) this device must accept any interference received, including interference that may cause undesirable operation. The radio receiver is not subject to above item (2).

Any unauthorized changes or modifications to this equipment would void the user's authority to operate this device.

Basic Operation

APE PLAYBACK

You can use normal position type tapes only.

Operation	Button/Selector
To stop	■
To fast forward or rewind	◀◀ or ▶▶*
To change the tape direction	DIR (FWD ↔ REV)

◀◀: Fast forward for the forward side

▶▶: Rewind for the forward side

RADIO RECEPTION

Operation	Button
To stop	•AM/FM/OFF

When selecting the band

press •AM/FM/OFF and release the button within 2 seconds.

Troubleshooting Guide

BEFORE CALLING



Before requesting service for this unit, check the chart below for a possible cause of the problem you are experiencing. Some simple checks or a minor adjustment on your part may eliminate the problem and restore proper operation.

If you are in doubt about some of the check points, or if the remedies indicated in the chart do not solve the problem, refer to the directory of Authorized Service Centers (enclosed with this unit) to locate a convenient service center, or consult your dealer for instructions.

For detailed instructions, contact an authorized servicenter in the U.S.A. 1-800-211-7262 or web site (<http://www.panasonic.com>).

Problem

Checkpoint

Radio operates but tape doesn't.

Is the battery worn?

No radio operations.

Is the unit in the hold state?

No operations.

Has the battery been installed with its polarities (⊕, ⊖) reversed?

•No sounds.
•VMSS does not function. (RQ-SW45V Only)
•A gritty noise is heard.

•Is the headphones plug firmly connected to the ⌀ jack?
•Is the plug dirty?

VMSS is not working very well.

Is the volume down too low? (The louder the volume, the better VMSS works.)



The LAP function

Can also be used when the unit is off.

LAP keeps track of time when you are jogging and listening to music.

1. Press LAP. (LAP is now on standby.)
You will see "00:00" or the last condition on the display.
2. Within 10 seconds press one of the LAP START buttons (1, 2, 3, 4, 5) to choose the LAP mode. (LAP is now on.)

•A tone sounds at the time set for each mode.

Mode 1	Every minute	beep
Mode 2	Every 5 minutes	beep
Mode 3	Every 10 minutes	beep
Mode 4	Every 15 minutes	beep
Mode 5	Every 30 minutes	beep beep

When LAP is on



Time passed Selected mode

Whichever mode you choose, "beep beep" sounds every 30 minutes and "beep bee...p" every 60 minutes.

To pause

Press LAP. The selected mode number flashes.

•The display clears after about 10 seconds.

To restart

1. Press LAP if the display has cleared.
2. ① To continue using the same mode
Press the LAP START button corresponding to the LAP mode number that is flashing.
② To change modes
Press the LAP START button of your choice.

To reset the time display

1. Press LAP if the display has cleared.
2. Press and hold LAP.
The display changes back to "00:00". (LAP is now on standby.)

When LAP is on standby:

- Pressing any LAP START button starts on.
- Pressing LAP turns the function off.
- LAP automatically switches off after about 10 seconds if left on standby.

If you ship the product

Carefully pack and send it prepaid, adequately insured and preferably in the original carton.

Attach a postage-affixed letter, detailing the complaint, to the outside of the carton.

Do NOT send the product to the Executive or Regional Sales offices. They are NOT equipped to make repairs.

Customer's Record

Model No. _____	Dealer's Name _____
Serial No. _____ or _____	_____
Code No. _____	Dealer's Address _____
Date of Purchase _____	_____

Panasonic Consumer Electronics Company, Division of Matsushita Electric Corporation of America
One Panasonic Way,
Secaucus, New Jersey 07094

Panasonic Audio Products Limited Warranty

Panasonic Sales Company, Division of Matsushita Electric of Puerto Rico, Inc. ("PSC")
Ave. 65 de Infantería, Km. 9.5
San Gabriel Industrial Park
Carolina, Puerto Rico 00985
Tel. (809) 750-4300
FAX. (809) 768-2910

Panasonic Consumer Electronics Company or Panasonic Sales Company (collectively referred to as "The warrantor") will repair this product with new or refurbished parts, free of charge, in the U.S.A. or Puerto Rico from the date of original purchase in the event of a defect in materials or workmanship as follows:

AUDIO COMPONENTS, RADIOS, COMPACT DISC PLAYERS, VIDEO CD PLAYERS AND HOME ENTERTAINMENT SYSTEMS—For one (1) year.

ACCESSORIES, HEADPHONES AND CARTRIDGES—(when applicable) For ninety (90) days.

BATTERIES—(when applicable)—New rechargeable batteries in exchange for defective rechargeable batteries—For ten (10) days. Non-rechargeable batteries are not warranted.

RECHARGEABLE BATTERY PACKS—(when applicable)—New rechargeable battery packs in exchange for defective rechargeable battery packs for (90) days. Non-rechargeable battery packs are not warranted.

Carry-in or mail-in service in the continental U.S.A. can be obtained during the warranty period from a Panasonic Services Company (PASC) Factory Servicenter listed in the Servicenter Directory. Or call 1-800-211-7262, toll free, to locate an authorized PASC Servicenter. Carry-in or mail-in service in Puerto Rico can be obtained during the warranty period by calling the telephone numbers listed in the Servicenter Directory.

This warranty is extended only to the original purchaser. A purchase receipt or other proof of date of original purchase will be required before warranty service is rendered.

This warranty only covers failures due to defects in materials or workmanship

which occur during normal use and does not cover normal wear to the stylus (when applicable) or dealer installed cartridge or stylus. It does not cover damage which occurs in shipment or failures which are caused by products not supplied by the warrantor or failures which result from accident, misuse, abuse, neglect, mishandling, misapplication, faulty installation, set-up adjustment, improper maintenance, alteration, improper antenna, inadequate signal pick-up, maladjustment of consumer controls, modification, or commercial use of product or service by anyone other than a PASC Factory Servicenter or authorized PASC Servicenter, or damage that is attributable to acts of God.

LIMITS AND EXCLUSIONS

There are no express warranties except as listed above.

THE WARRANTOR SHALL NOT BE LIABLE FOR INCIDENTAL OR CONSEQUENTIAL DAMAGES RESULTING FROM THE USE OF THIS PRODUCT, OR ARISING OUT OF ANY BREACH OF THIS WARRANTY, INCLUDING WITHOUT LIMITATION, DAMAGE TO TAPES RECORDS OR DISCS. ALL EXPRESS AND IMPLIED WARRANTIES INCLUDING THE WARRANTIES OF MERCHANTABILITY AND FITNESS FOR A PARTICULAR PURPOSE, ARE LIMITED TO THE APPLICABLE WARRANTY PERIOD SET FORTH ABOVE. Some states do not allow the exclusion or limitation of incidental or consequential damages, or limitations on how long an implied warranty lasts, so the above exclusions or limitations may not apply to you.

This warranty gives you specific legal rights and you may also have other rights which vary from state to state.

If a problem with this product develops during or after the warranty period, you may contact your dealer or Servicenter. If the problem is not handed to your satisfaction, then write to the Consumer Affairs Division at the company address indicated above.

Product Service

Do not attempt to remove the cover(s) or repair the unit yourself. Refer servicing to qualified personnel only.

Product Information

For product service, product information or assistance with product operation, refer to the servicenter directory.

User memo:

DATE OF PURCHASE _____
DEALER NAME _____
DEALER ADDRESS _____
TELEPHONE NUMBER _____

Technical Specifications

Radio frequency range:	FM: 87.9–107.9 MHz (0.2 MHz steps) 87.5–108.0 MHz (0.1 MHz/0.05 MHz steps) AM: 520–1710 kHz (10 kHz steps) 522–1629 kHz (9 kHz steps)
Frequency range:	40–16000 Hz (Normal)
Tape speed:	4.8 cm/s (1½ ips)
Jack:	Output: HEADPHONES
Power requirement:	Battery: DC 1.5 V (R6/LR6, AA, UM-3 battery)
Dimensions (W×H×D):	90.9×117.7×37.4 mm (3½×4½×1½")
Weight (without battery):	253 g (8.9 oz.)

Play time:

[When used in hold mode, at 25°C (77°F) and on flat and stable surface]

Panasonic alkaline dry cell battery; (RQ-SW45V)
Tape: About 22 hours
Radio: About 25 hours (RQ-SW35V)
Tape: About 24 hours
Radio: About 28 hours

•The play time may be less depending on the operating conditions.

LAP



- The time interval between tones is shown for about one second before LAP comes on.
- The display reverts to "00:00" after "59:59" is displayed.
- The display changes if a button is pressed when LAP is on, but the time display returns after 3 seconds.

- The LAP function may not operate if the battery is running low.
- These graphics scroll on the display when LAP is on (RQ-SW35V only):



BATTERY



- Observe polarity to avoid leakage and damage to the unit.
- Remove the battery if the set will not be used for a long period of time.

- If rechargeable batteries are to be used, rechargeable batteries manufactured by Panasonic are recommended.

Battery condition indicator

The indicator is shown whenever the radio is on or a tape is traveling.



- When you start a tape or radio reception, the indicator scrolls 2 times before it lights.
- When you press BATT CHECK in the stop mode, the indicator scrolls 2 times and lights for about 5 seconds.

When the battery is weak
The indicator will flash and then:

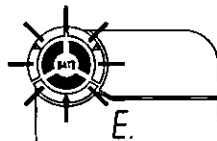

- Leaving the unit in this condition erases the contents of the memory. Replacing the batteries within 30 seconds will retain any stored information.

CAUTION



- Avoid using or placing this unit near sources of heat. Do not leave it in an automobile exposed to direct sunlight for a long period of time with doors and windows closed.

- To avoid product damage, do not expose this product to rain, water or other liquids.

Water-resistant (Splashproof)

This unit is splashproof and is not designed to be used under water.

Please note the following points to avoid possible damage to the unit or the headphones.

- Do not immerse set in water or splash excessive amounts of water onto it.
- If the unit or the headphones get wet with water or sweat, dry them with a soft cloth.
- Do not open the cassette holder near water or sand.
- Make sure there is no sand or dust around the cassette holder.

- Do not expose the unit or the headphones to salt water.
- Since water in the headphones jack may cause damage, cover it with attached rubber cap when the headphones are not in use.
- Do not leave the unit and the headphones for a long period of time in high temperature and high humidity areas such as bathrooms or damp basements, etc.
- To prevent water from entering the cassette compartment, be sure to turn OPEN LOCK until it locks the cassette holder closed.

Listening caution



Do not play your headphones or earphones at a high volume. Hearing experts advise against continuous extended play.

If you experience a ringing in your ears, reduce volume or discontinue use.

Do not use while operating a motorized vehicle. It may create a traffic hazard and is illegal in many areas.

You should use extreme caution or temporarily discontinue use in potentially hazardous situations. Even if your headphones or earphones is an open-

air type designed to let you hear outside sounds, don't turn up the volume so high that you can't hear what's around you.

Sound can be deceiving. Over time your hearing "comfort level" adapts to higher volumes of sound. So what sounds "normal" can actually be loud and harmful to your hearing.

Guard against this by setting your equipment at a safe level BEFORE your hearing adapts.

To establish a safe level:

- Start your volume control at a low setting.
 - Slowly increase the sound until you can hear it comfortably and clearly, and without distortion.
- Once you have established a comfortable sound level:
- Set the dial and leave it there.

MAINTENANCE



To ensure good sound quality, clean the head after approximately every 10 hours of use with a cotton swab dampened with a little alcohol.

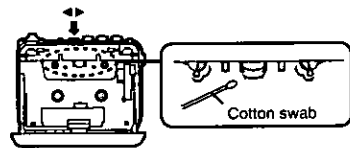

TAPE



Auto reverse

Play will continue, looping forward and reverse sides, until ■ (stop button) is pressed.

Notes:

- Before playback, be sure to set •AM/FM/OFF to "OFF".
- When closing the cassette holder, be sure to push the cassette holder firmly against the unit, and turn OPEN LOCK until it locks.
- Do not open the cassette compartment cover during tape operation.

- Between functions (during play, fast forward or rewind), always press ■ (stop button) first to avoid jamming the tape.
- When the tape reaches the end after fast forward or rewind, press ■ (stop button) to release the button.
- If you press •AM/FM/OFF to switch on the radio during tape operation, the buttons will not be released even though the motor has stopped. Press ■ (stop button) to release the button.

RADIO



Concerning the hold function

This function prevents the unit from operating even if one of the front panel buttons is pressed in error.

During hold state

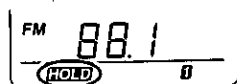

If a button is pressed.

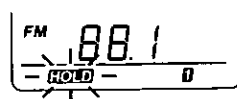

To obtain good reception

FM:

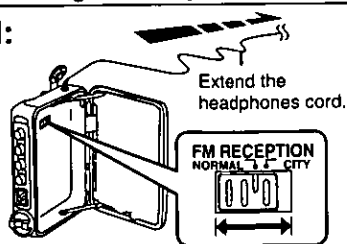

How to receive FM broadcast clearly
Set FM RECEPTION to **NORMAL**.
When the FM reception is impaired, or there is interference from a powerful station, set it to **CITY**.

AM:



■ **When a station is tuned in.**

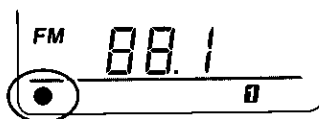

Preset tuning

A total of 20 stations can be stored as follows:

MODE 1: FM 1-5, AM 1-5

MODE 2: FM 1-5, AM 1-5

We recommend that you use MODE 1 for daily use, and MODE 2 for travel.

■ Mode selection

Press and hold **MODE** for more than 2 seconds. "1" (MODE 1) or "2" (MODE 2) is shown on the display.

■ Memory presetting

1. Tune in the station to be stored.

2. Press and hold one of the memory buttons (1, 2, 3, 4, 5) for about 2 seconds.

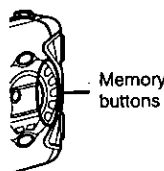

3 beeps can be heard.

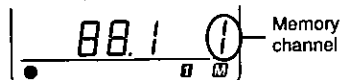

To recall a preset station
Press a memory button (1, 2, 3, 4, 5).
● Release the button within 2 seconds.

When using overseas

Allocations need to be changed according to the area.

Every time the following procedure is performed, the allocation setting changes as follows:

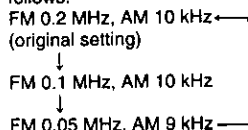

■ How to adjust the allocation settings

- Press and hold **MODE** to select the mode (MODE 1 or MODE 2).
- While pressing **BATT CHECK**, press and hold **MODE** for about 3 seconds.
● The changed allocation settings (FM and then AM) are displayed.

Note:

Converting the allocation erases the stations previously stored in memory.

BASS



VMSS (RQ-SW45V) or XBS (RQ-SW35V) does not function for AM reception.

If you press **VMSS ON/OFF** (RQ-SW45V) or **XBS ON/OFF** (RQ-SW35V) during AM reception, "E." is shown on the display.

VMSS (RQ-SW45V)

Boosts the low frequency range. The earpieces of the included headphones vibrate, making the sound seem more vigorous. Raising the volume intensifies the effect.

● The effect may be reduced with some sources.

● If you experience a ringing or discomfort in your ear while listening in VMSS mode, reduce volume or turn the VMSS mode OFF.

- The brain graphics are displayed when VMSS is on.
- The graphics scroll as follows when the VMSS effects are strong.

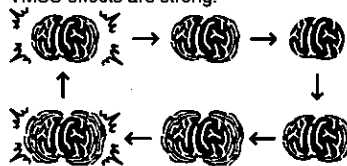

The brain gets smaller when the VMSS effects are weaker.

XBS (RQ-SW35V)

Boosts the low frequency range.

● If distortion occurs, turn down the volume.